

# Product Overview

## COMBINATION POSSIBILITIES

Whether you need single-arm or double-arm illumination of a larger area or just a small detail, use our overview to find the right light guide and combine it with a light source.

### Large-area Illumination

Ring lights (p. 69)



### Detailed Illumination

Light guides made of optical glass, one- and two-armed (p. 70 ff)



Goose neck light guide (p. 73)



FlexiLux 4000 LED light source (p. 60)



Universal light guides (p. 74)



Diagnostic light guide (p. 73)



Light guides made of optical glass, single usage and combinable (p. 71)



optional

Light probes (p. 72)



# FLEXILUX Fiberoptical Ring Light

## FLEXILUX FIBEROPTICAL RING LIGHT

The FlexiLux ring lights combine compact yet robust design using glass fibers, providing a homogenous and shadow-free illumination of the working area.

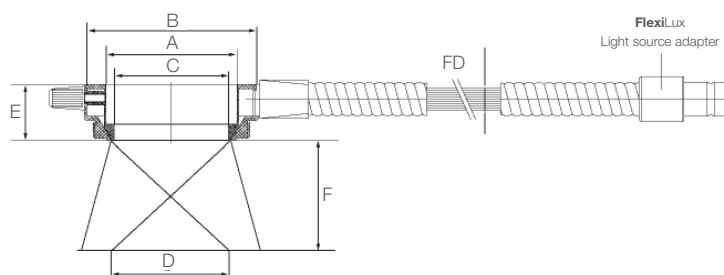

Item number	A Connection Ø	B Outer Ø	C Inner Ø	D Illumination field	E Height	F Working distance	FD Active Ø	Cable length
10.485	66.2 mm	93.0 mm	57.0 mm	50 - 100 mm	25.0 mm	45 - 125 mm	10.0 mm	750 mm
10.486*	58.2 mm	78.0 mm	51.0 mm	50 - 100 mm	25.0 mm	24 - 80 mm	9.1 mm	750 mm
RLRV.2238.1500	22.0 mm	38.0 mm	22.0 mm	25 - 50 mm	16.0 mm	5 - 80 mm	4.0 mm	1,500 mm

Further types will be verified on request.

\* integrated adaption possibility for ring mirror fixture

# Light Guides Made of Optical Glass, One-Armed

## LIGHT GUIDES MADE OF OPTICAL GLASS ONE-ARMED

These single-armed light guides are usable in numerous industrial applications. They are covered with a metal spiral hose with PVC coating and are fully flexible. At the end, where the light emerges, the light guide is equipped with an end sleeve for fixation.

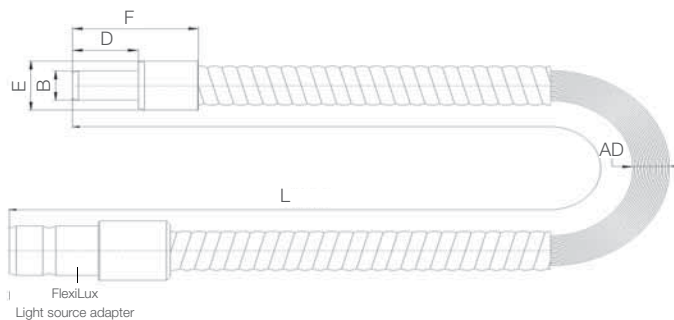

Item number	AD Active Ø	L Length	B Ferrule Ø	D Ferrule length	E Max. outer Ø	F Length metal end
LOG2.401000.FX	4.0 mm	1,000 mm	6.0 mm	12.0 mm	10.0 mm	24.0 mm
LOG2.401500.FX	4.0 mm	1,500 mm	6.0 mm	12.0 mm	10.0 mm	24.0 mm
LOG2.402000.FX	4.0 mm	2,000 mm	6.0 mm	12.0 mm	10.0 mm	24.0 mm
LOG2.501000.FX	5.0 mm	1,000 mm	7.0 mm	16.0 mm	12.0 mm	31.0 mm
LOG2.501500.FX	5.0 mm	1,500 mm	7.0 mm	16.0 mm	12.0 mm	31.0 mm
LOG2.502000.FX	5.0 mm	2,000 mm	7.0 mm	16.0 mm	12.0 mm	31.0 mm
LOG2.601000.FX	6.0 mm	1,000 mm	8.0 mm	16.0 mm	14.0 mm	30.7 mm
LOG2.601500.FX	6.0 mm	1,500 mm	8.0 mm	16.0 mm	14.0 mm	30.7 mm
LOG2.602000.FX	6.0 mm	2,000 mm	8.0 mm	16.0 mm	14.0 mm	30.7 mm
LOG2.801000.FX	8.0 mm	1,000 mm	10.0 mm	20.0 mm	17.0 mm	36.7 mm
LOG2.801500.FX	8.0 mm	1,500 mm	10.0 mm	20.0 mm	17.0 mm	36.7 mm
LOG2.802000.FX	8.0 mm	2,000 mm	10.0 mm	20.0 mm	17.0 mm	36.7 mm

Further types will be verified on request.

# Light Guides

## LIGHT GUIDE MADE OF OPTICAL GLASS – TWO-ARMED, FULLY FLEXIBLE

Two-armed light guides are used for applications in which two light outputs from one light source are needed. The light guide is covered with a metal spiral hose with PVC coating but is also fully flexible. At the end where the light emerges, the light guide is equipped with an end sleeve for fixation.



Item number	Active Ø arm	Arms	Active Ø common	Length
10.470	9.0 mm	2	12.7 mm	1,000 mm

## LIGHT GUIDE MADE OF OPTICAL GLASS – SINGLE-ARMED, FULLY FLEXIBLE AND VERY ROBUST

These light guides are very robust, especially on the heavily stressed ends protected against fiber fracture. The flexible part is strengthened with a spiral spring for bend protection on the side of the light source and with an additional shrinking hose on the side of light output.



Item number	Active Ø	Length
12.578.002	4.0 mm	1,800 mm
12.580.001	6.0 mm	1,800 mm
12.581.001	6.0 mm	3,000 mm

# Probe Handle and Light Probes

## PROBE HANDLE

For illumination of the interior of objects, the SCHÖLLY light guide probes offer several possibilities. Connect your light guide with the probe handle and attach the required light probe.



Item number	Outer Ø	Length
12.606	15.0 mm	75 mm

1 - fits to probe light guide item no. 12.580.001 and 12.581.001

2 - fits to light probes and annular mirror probes (fixation via clamping nut inside handle)

## LIGHT PROBES



Item number	Active Ø	Outer Ø	Length	Form
12.609	2.0 mm	3.0 mm	100 mm	straight
12.610	4.0 mm	5.0 mm	100 mm	straight
12.610.006	4.0 mm	5.0 mm	400 mm	straight
12.612	4.0 mm	5.0 mm	200 mm	straight
12.615	4.0 mm	5.0 mm	115 mm	45° angled

# Goose Neck Light Guide, Diagnostic Light Guide

## GOOSE NECK LIGHT GUIDE - TWO-ARMED, SEMI-FLEXIBLE

Illuminate your working area precisely with the SCHÖLLY goose neck light guide. Due to its semi-flexible construction, it is possible to adjust the light guide individually. The arms do not wear down due to their vertical set. The black color of the outer material reduces reflections from the light guide to the working area.



Item number	Active Ø arm	Arms	Active Ø common	Length
10.466	5.5 mm	2	7.8 mm	600 mm

## DIAGNOSTIC LIGHT GUIDE MADE OF SYNTHETIC WITH PROBE

incl. handle, with FlexiLux light source adapter



Item number	Active Ø	Length	Probe Ø	Probe length
12.608	1.5 mm	2,000 mm	2.0 mm	50 mm

# Universal Light Guides

## UNIVERSAL LIGHT GUIDE MADE OF SYNTHETIC - FULLY FLEXIBLE WITH TEN SINGLE ARMS

Hard-to-access areas can be illuminated with this light guide. The ten single arms allow an illumination in several apertures. The arms can be bent under heat for an individual justification depending of your application. If required, synthetic fibers can be cut.



Item number	Arms	Length	Active Ø
12.592	10	2,000 mm	1.0 mm

## UNIVERSAL LIGHT GUIDE MADE OF SYNTHETIC - FULLY FLEXIBLE WITH TEN SINGLE ARMS, ROBUST VERSION

Additional covering of each arm, robust version with additional bend protection.



Item number	Arms	Length	Active Ø
LGPM.1004200	10	2,000 mm	1.0 mm